



DAVIDSONS
HOMES

THE BRADFIELD
2 BEDROOM
MID-TERRACE
HOME

An exclusive opportunity to own
a desirable new property that
provides comfortable living with
craftsmanship of the highest calibre.

DH250L-3
[598]
Rev C01



DAVIDSONS HOMES

THE BRADFIELD FLOOR PLANS

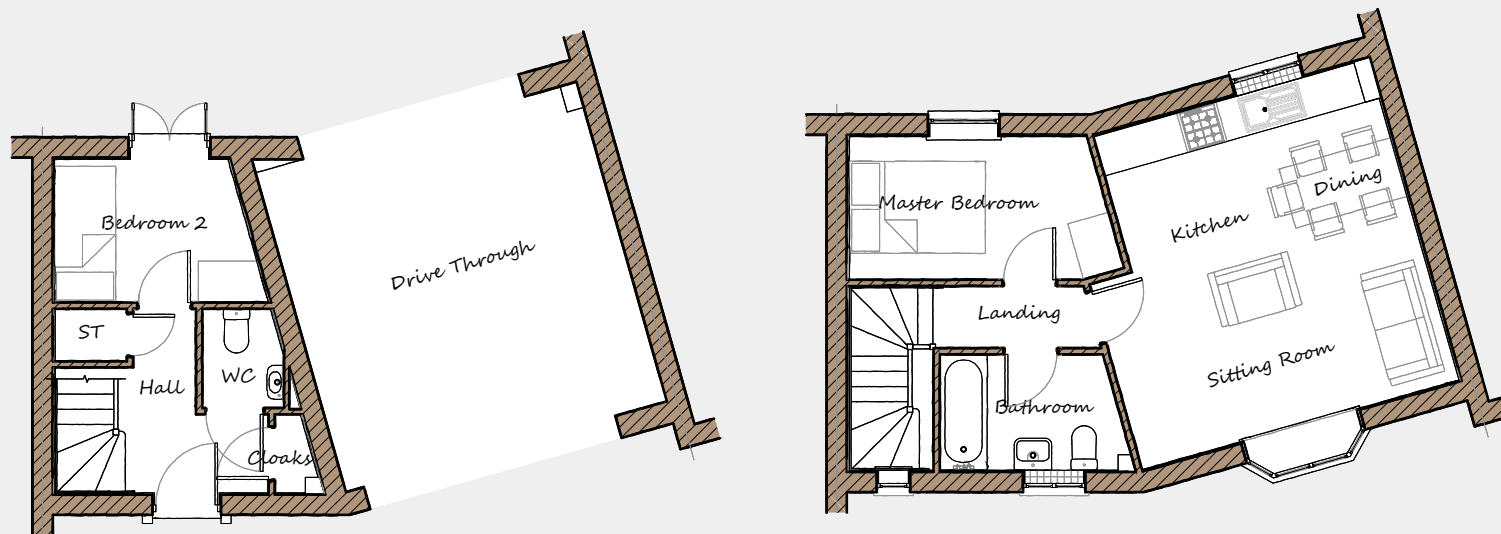

Ground Floor

Bedroom 2	3145	x	2105	10'4"	x	6'11"
WC	1200	x	1460	3'11"	x	4'9"

First Floor

Sitting Room	4840	x	2830	15'11"	x	9'3"
Kitchen / Dining	4195	x	2070	13'9"	x	6'10"
Master Bedroom	4040	x	2105	13'3"	x	6'11"
Bathroom	2815	x	1700	9'3"	x	5'7"

This is an artistic interpretation, therefore variations in finishes and exact layout may not be accurate. Please ask your Sales Manager for complete specifications. Images are for illustration purposes only. Please be aware that a tolerance of 50mm should be taken into consideration for plasterboard and brickwork. Measurements provided are maximum measurement information for the space.



Davidsons Homes.
Wilson House, Leicester Road,
Ibstock, Leicestershire, LE67 6HP
T: 01530 261 444
www.davidsonsgroup.co.uk