



DAVIDSONS
HOMES

THE NEWPORT
3 BEDROOM
DETACHED
HOME

An exclusive opportunity to own
a desirable new property that
provides comfortable living with
craftsmanship of the highest calibre.

DH319G
[978]

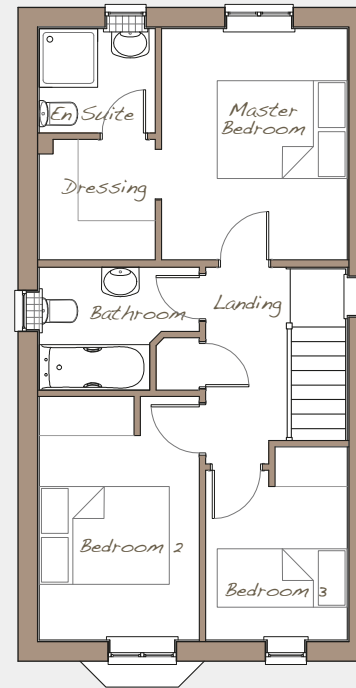
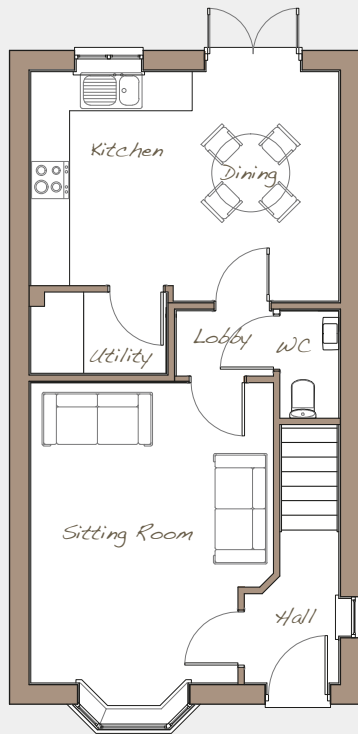

DAVIDSONS HOMES

THE NEWPORT FLOORPLANS

Ground Floor

Sitting Room	3730	x	4960	12'2"	x	16'3"
Kitchen/Family/Diner	4730	x	3525	15'5"	x	12'1"
Utility	2080	x	1245	6'8"	x	4'1"
WC	900	x	1645	3'0"	x	5'4"

First Floor

Master Bedroom	2850	x	3550	9'4"	x	11'6"
En Suite	1780	x	1600	5'8"	x	5'2"
Dressing	1780	x	1845	5'8"	x	6'1"
Bedroom 2	2460	x	3740	8'1"	x	12'3"
Bedroom 3	2170	x	2965	7'1"	x	9'7"
Bathroom	2460	x	1885	8'1"	x	6'2"

This is an artistic interpretation, therefore variations in finishes and exact layout may not be accurate. Please ask your Sales Manager for complete specifications. Images are for illustration purposes only. Please be aware that a tolerance of 50mm should be taken into consideration for plasterboard and brickwork. Measurements provided are maximum measurement information for the space.



Davidsons Group.
Wilson House, Leicester Road,
Ilbstock, Leicestershire, LE67 6HP
T: 01530 261 444
F: 01530 267 140
www.davidsonsgroup.co.uk